

P.C.B. LAYOUT

CIRCUIT DIAGRAM

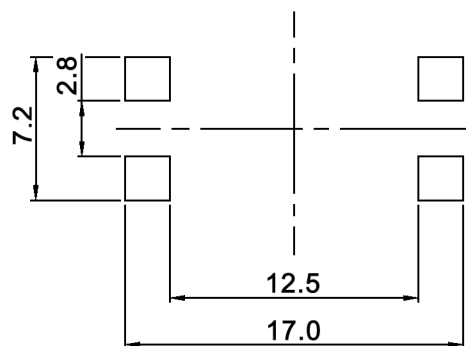
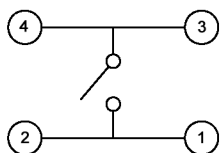

Tolerances: max. ±0.2mm	Date	Name
	05/10	dr
Sealing	09/10	dr
Modifications	Date	Name

**TSSE 24 x**

**30 21 01**

Page

1/2

**Specifications:**

**Contact rating:** 50mA, 50V DC  
**Contact resistance:** 100mOhm max.  
**Insulation resistance:** 1 000MOhm min. at 100V DC for 1 minute +/-5sec.  
**Dielectric strength:** 250V AC (50/60Hz) for 1 minute  
**Operating temperature:** -40°C to +85°C  
**Storage temperature:** -40°C to +85°C  
**Travel:** 0.35 +/-0.15mm  
**Material:** Stem: high-temp. thermoplastic nylon UL94V-0  
                   Cover: stainless steel  
                   Seal: silicone rubber, molded black  
                   Contact: stainless steel, silver plated  
                   Terminal: brass, silver plated  
                   Base: high-temp. thermoplastic LCP, molded black  
                   IP 67

**Sealing:**  
**Soldering conditions:**

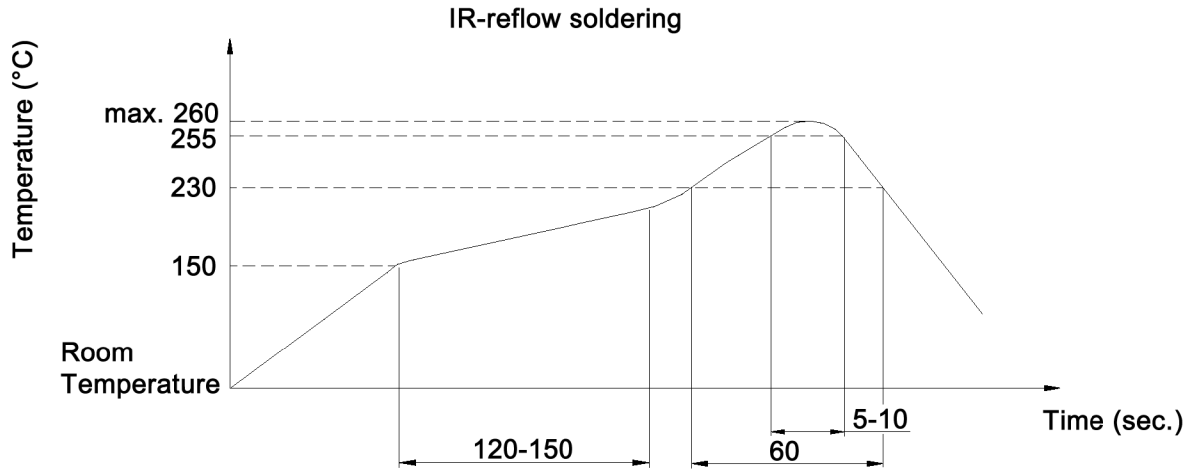

x	Operating force (gf)	Mechanical life	Color of stem
N	160 +/-50	1 000 000 cycles	brown
R	260 +/-50	1 000 000 cycles	red



Tolerances: max. ±0.2mm		Date	Name	<h1>TSSE 24 x</h1>
		05/10	dr	
		<b>knitter-switch</b>		<h2>30 21 01</h2>
				Page 2/2
Modifications	Date	Name		