

P.C.B. LAYOUT

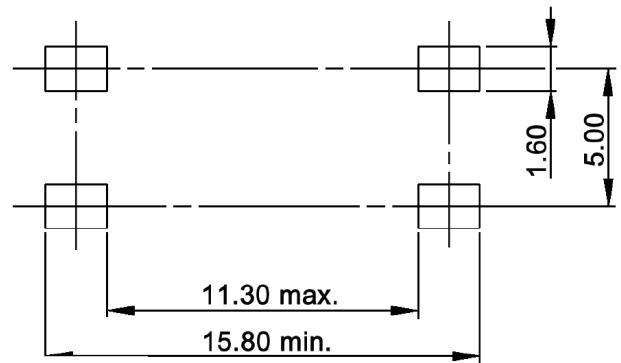

Specifications:

Contact rating: 100mA, 42V DC/AC max.
(0.01mA, 0.02V DC/AC min.)

Switching power: 1W max.

Contact resistance: 100mOhm max.

Insulation resistance: 1 000MOhm

Dielectric strength: 150V AC (50Hz)

Operating temperature: -40°C to +80°C

Mechanical life: 1 000 000 cycles

Operating force: 680 +/-100gf

Travel: 0.61 +/-0.1mm

Packaging unit: 750 pcs. / reel

Material: All plastic material UL94HB

Contact: stainless steel, gold plated over nickel

Terminal: brass, tin over nickel

CIRCUIT DIAGRAM

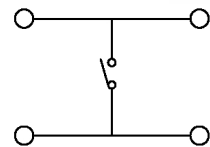

Tolerances: <10: ±0.2mm 10-30: ±0.3mm	Date	Name
	11/08	dr

TSSE 12-680

knitter-switch		
Plating	01/11	dr
Modifications	Date	Name

30 16 58

Page

1/2

Soldering conditions:

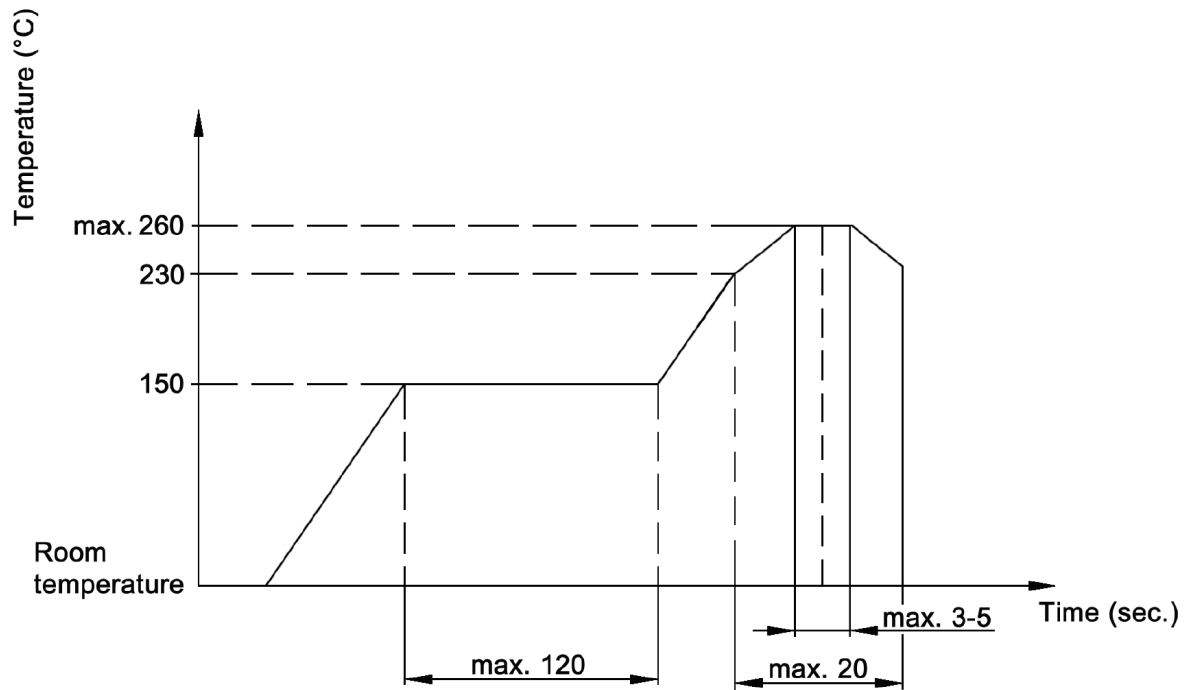

Tolerances: <10: ±0.2mm 10-30: ±0.3mm	Date	Name
	11/08	dr
Modifications	Date	Name

TSSE 12-680

knitter-switch

30 16 58

Page

2/2