

CIRCUIT DIAGRAM

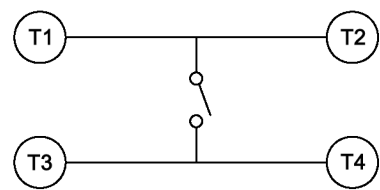

P.C.B. LAYOUT

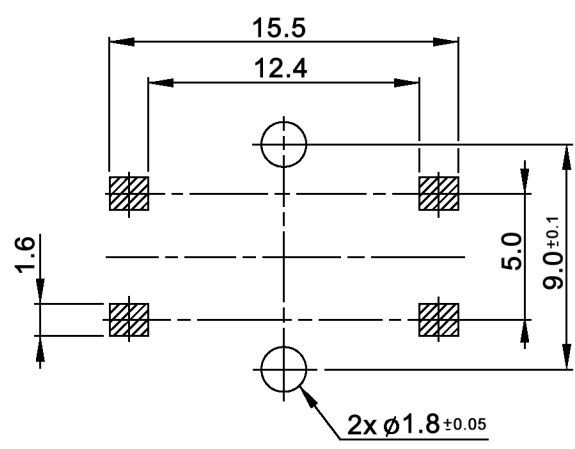

Tolerances: max. ±0.2mm	Date	Name
	04/10	dr
Modifications	Date	Name

TSS 24 P x

30 20 59

knitter-switch

Specifications:

Contact rating: 50mA, 12V DC
 Contact resistance: 100mOhm max.
 Insulation resistance: 100MOhm min. at 500V DC for 1 minute +/-5sec.
 Dielectric strength: 250V AC (50/60Hz) for 1 minute
 Operating temperature: -25°C to +70°C
 Storage temperature: -30°C to +80°C
 Travel: 0.35 +/-0.1mm
 Soldering conditions:

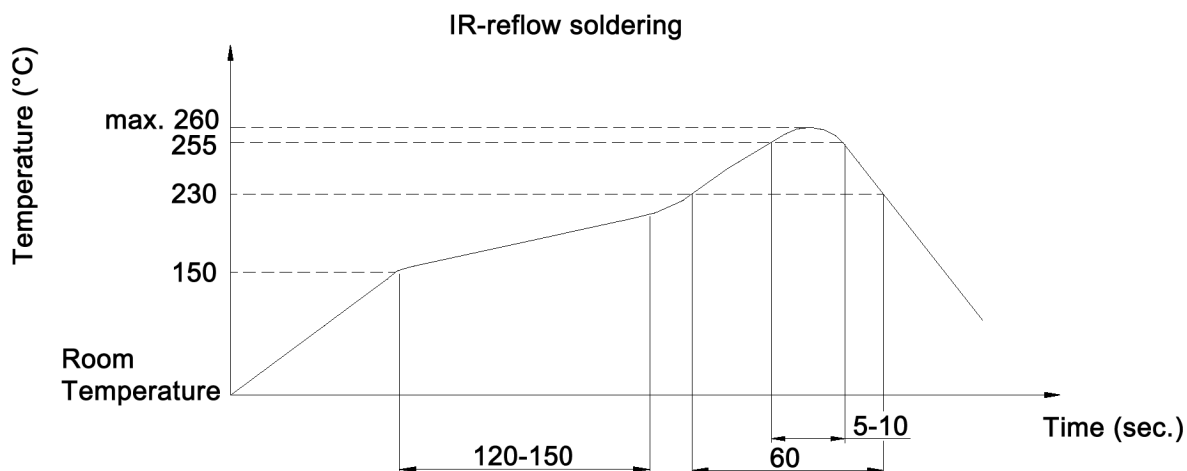

Material:
 Cover: stainless steel
 Stem: high-temp. thermoplastic nylon UL94V-0
 Contact: phosphor bronze, silver cladding
 Base: high-temp. thermoplastic nylon UL94V-0, molded brown
 Terminal: brass, silver plated

x	Operating force	Stem colour	Mechanical life
N	160 +/-50gf	brown	200 000 cycles
R	260 +/-50gf	red	100 000 cycles
S	320 +/-80gf	salmon	50 000 cycles



Tolerances: max. ±0.2mm		Date	Name	<h1>TSS 24 P x</h1>
		04/10	dr	
		knitter-switch		30 20 59
				Page
				2/2
Modifications	Date	Name		