

P.C.B. LAYOUT

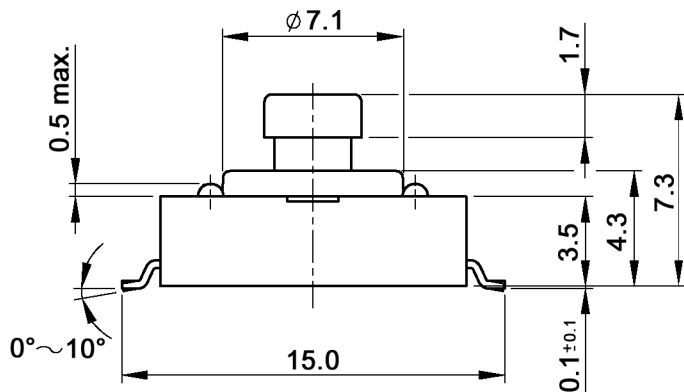
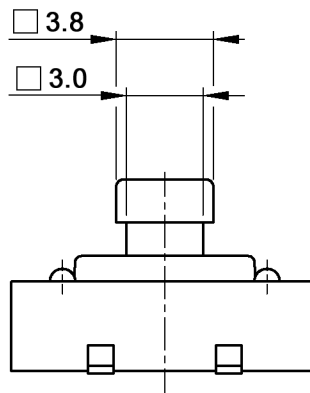
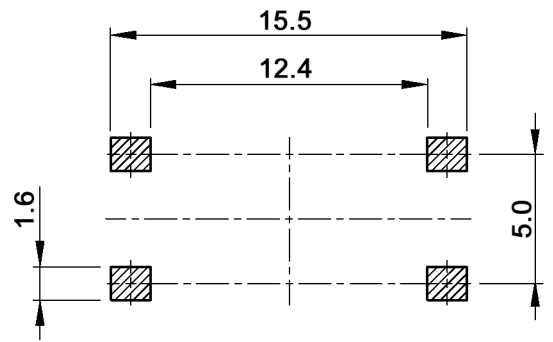

Specifications:

- Contact rating: 12V DC, 50mA
- Contact resistance: 100mOhm max.
- Insulation resistance: 100MOhm min. at 500V DC for 1 minute
- Dielectric strength: 250V AC (50Hz or 60Hz) for 1 minute
- Operating temperature: -25°C to +70°C
- Storage temperature: -30°C to +80°C
- Operating force: 160 +/-50g
- Color of stem: brown
- Mechanical life: 1 000 000 cycles

CIRCUIT DIAGRAM

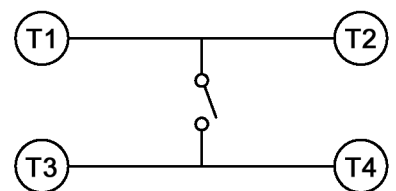

Material:

- Cover: stainless steel
- Stem: high-temp. thermoplastic nylon UL94V-0
- Contact: stainless steel, silver plated
- Base: high-temp. thermoplastic nylon UL94V-0, molded brown
- Terminal: brass, silver plated

Maßstab	Datum	Name	<h1>TSS 24 N-LL</h1>	
Oberfläche	12/06	dr		
			<h2>30 10 35</h2>	
			<b>knitter-switch</b>	
Zust	Änderung	Datum	Name	Blatt 1/2

## Soldering profile:

### ■ Condition for soldering

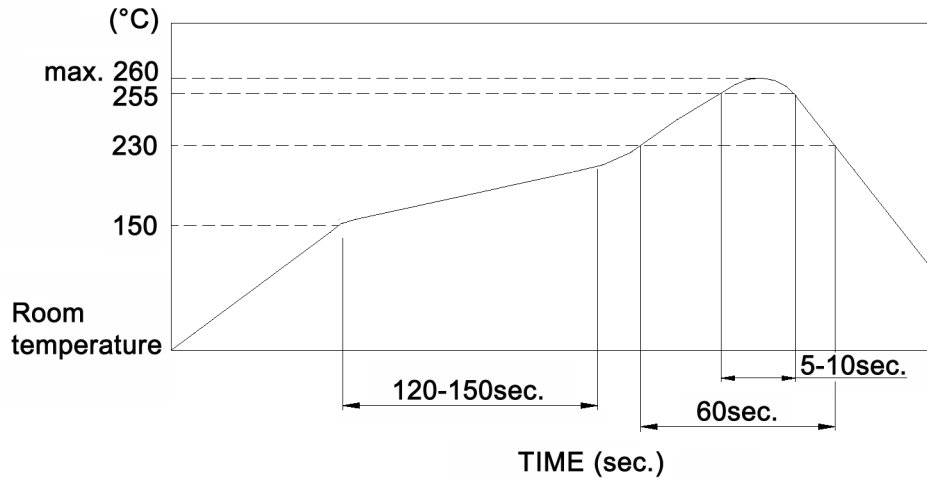

- The condition mentioned above is the temperature on the Cu foil of the PCB surface. There are cases where board's temperature greatly differs from switch's surface be used not to allow switch's surface temperature to exceed 260°C.

### ■ Manual soldering

Soldering temperature	max. 350°C
Continuous soldering time	max. 5 seconds

### ■ Precautions in handling

1. Care should be exercised so that flux from the upper part of the printed circuit board does not adhere to the switch.
2. Except for washable type do not wash the switch body.
3. Please make sure that there is no flux rose over the surface of the PCB.

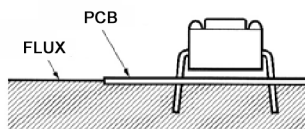

Maßstab		Datum	Name	<h1>TSS 24 N-LL</h1>
Oberfläche		12/06	dr	
		<b>knitter-switch</b>		<h1>30 10 35</h1>
Zust	Änderung	Datum	Name	Blatt 2/2