

P.C.B. LAYOUT

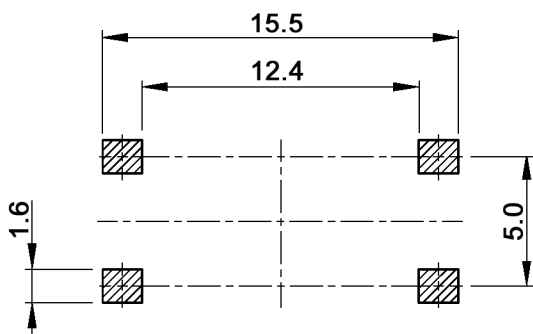

CIRCUIT DIAGRAM

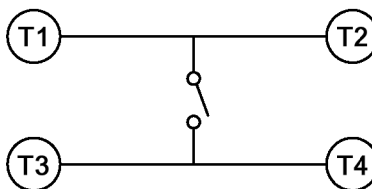

Tolerances: max. ±0.20mm	Date	Name	TSS 21 xS
	08/10	dr	
Table x	03/12	dr	30 21 52
Table x	06/11	dr	
Modifications	Date	Name	Page
			1/2

knitter-switch

30 21 52

Specifications:

Contact rating: 50mA, 12V DC
Contact resistance: 100mOhm max.
Insulation resistance: 100MOhm min. at 500V DC for 1 minute +/-5sec.
Dielectric strength: 250V AC (50/60Hz) for 1 minute
Operating temperature: -25°C to +70°C
Storage temperature: -30°C to +80°C
Travel: 0.35 +/-0.1mm
Material: Cover: stainless steel
 Stem: high-temp. thermoplastic nylon UL94V-0
 Contact: stainless steel dome, silver cladding
 Base: high-temp. thermoplastic nylon UL94V-0
 Terminal: brass, silver plated

Soldering conditions:

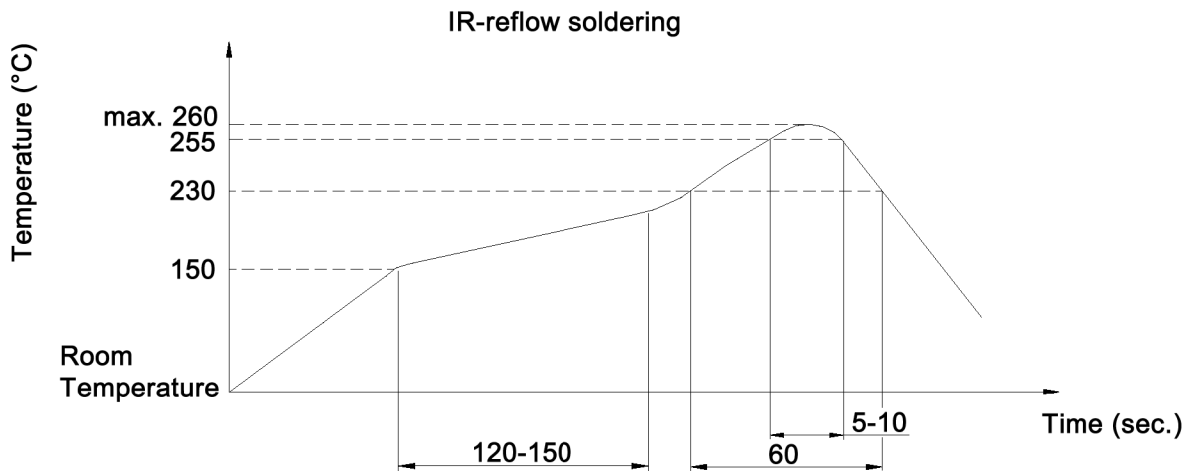

x	Operating force (gf)	Electrical life	Colour of stem
K	130 +/-50	10 000 000 cycles	black
N	160 +/-50	1 000 000 cycles	brown
R	260 +/-50	500 000 cycles	red



Tolerances: max. ±0.20mm		Date	Name	<h1>TSS 21 xS</h1>
		08/10	dr	
		knitter-switch		<h2>30 21 52</h2>
				Page 2/2
Modifications	Date	Name		