

P.C.B. LAYOUT

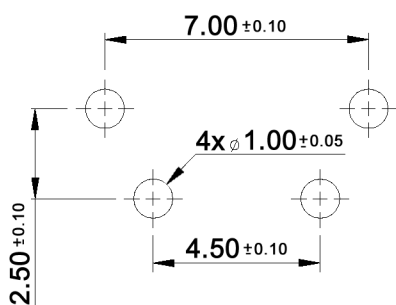

CIRCUIT DIAGRAM

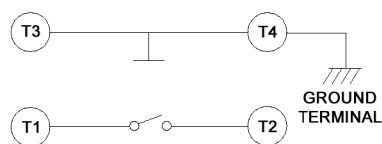

Tolerances: ±0.20mm			Date	Name
			06/09	dr
Modifications			Date	Name

TS 62 KS-RA

knitter-switch

30 18 44

Page

1/2

Specifications:

Contact rating: 50mA, 12V DC
 Contact resistance: 100mOhm max.
 Insulation resistance: 100MOhm min. at 50V DC
 Dielectric strength: 250V AC for 1 minute
 Operating temperature: -25°C to +70°C
 Storage temperature: -30°C to +80°C
 Electrical life: 1 000 000 cycles
 Operating force: 100 +/-50gf
 Travel: 0.25 +0.2/-0.1mm
 Material: Cover: steel, tin plated
 Stem / base: UL94V-0, thermoplastic nylon, black
 Contact disc: stainless steel
 Terminal: brass with silver plated

Soldering conditions:

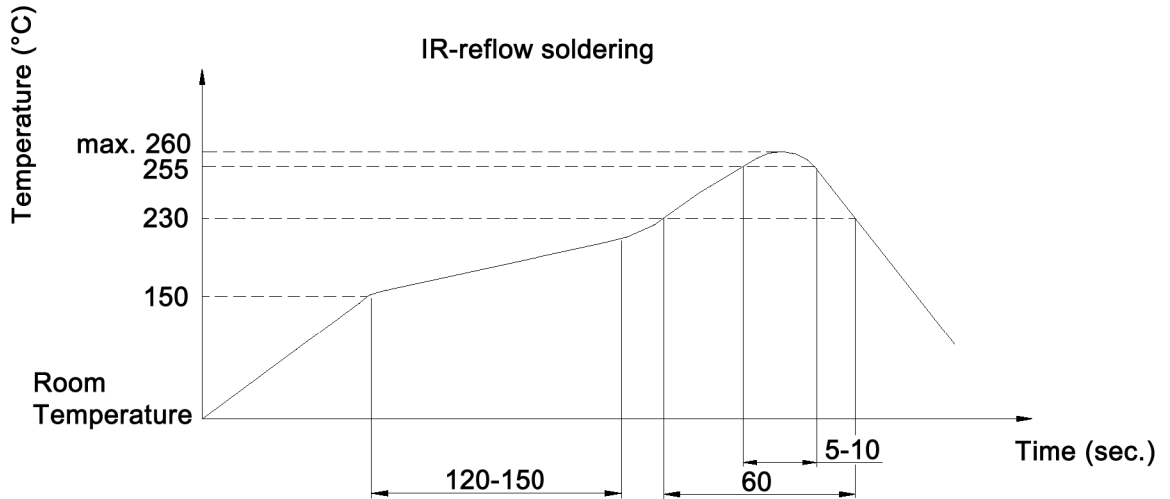

Tolerances: ±0.20mm			Date	Name	TS 62 KS-RA
			06/09	dr	
			knitter-switch		30 18 44
Modifications			Date	Name	Page 2/2