

LED

CIRCUIT DIAGRAM

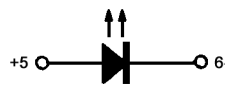
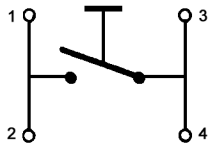

x	Color	I _F (mA)	U _F (V)
R	red	10	2.1
G	green		
Y	yellow		

P.C. MOUNTING

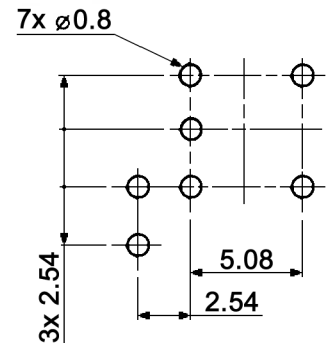

Specifications:

Contact rating:

TR: 10mA, 12V DC
TM: 50mA max., 48V DC, 1W

Contact resistance:

TR: 500Ohm max. at 1.5N operating force
TM: 100mOhm max. at 2N operating force

Insulation resistance:

100MOhm min. at 100V DC

Dielectric strength:

250V, 50Hz for the duration of 1 minute

Operating temperature:

-25°C to +70°C

Electrical life:

TR: min. 100 000 cycles
TM: min. 300 000 cycles

Soldering conditions:

TR: auto-soldering: max.: 245 +/-10°C, 3sec.
TM: auto-soldering: max.: 300°C, 5sec.

Switching function:

off - mom

Mounting:

TR: 1.0mm

TM: 0.25mm

Mounting:

on pc-board

Material:

Contacts: TR: rubber contact bridge; fixed contact phosphor bronze, gold plated
TM: metal contact; stainless steel, silver plated

Terminals: PC terminals; TR: gold plated

TM: silver plated

Button: PBT

Case: TR: PA meets UL94V-0

TM: 6T PA resin

Caps: ABS



Tolerances:	Date	Name
		01/09
Modifications	Date	Name

TR 3-Lx / TM 3-Lx

knitter-switch

20 09 91

Page

1/2

Caps:

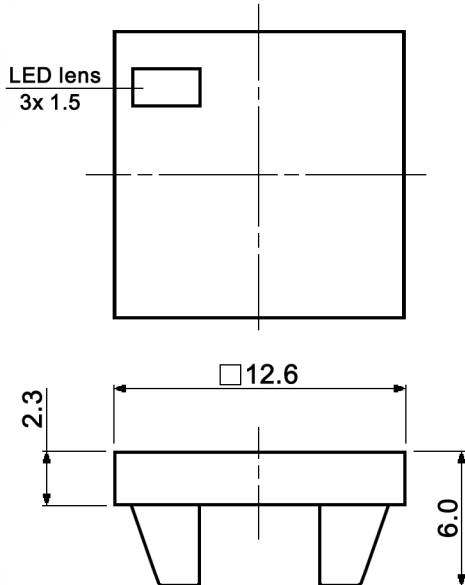

- | | |
|------------|---------|
| dark grey | KT 3117 |
| grey | KT 3107 |
| light grey | KT 3127 |
| ivory | KT 3111 |
| silver | KT 3121 |
| red | KT 3109 |
| green | KT 3106 |
| blue | KT 3104 |
| brown | KT 3102 |

Mounting dimensions:

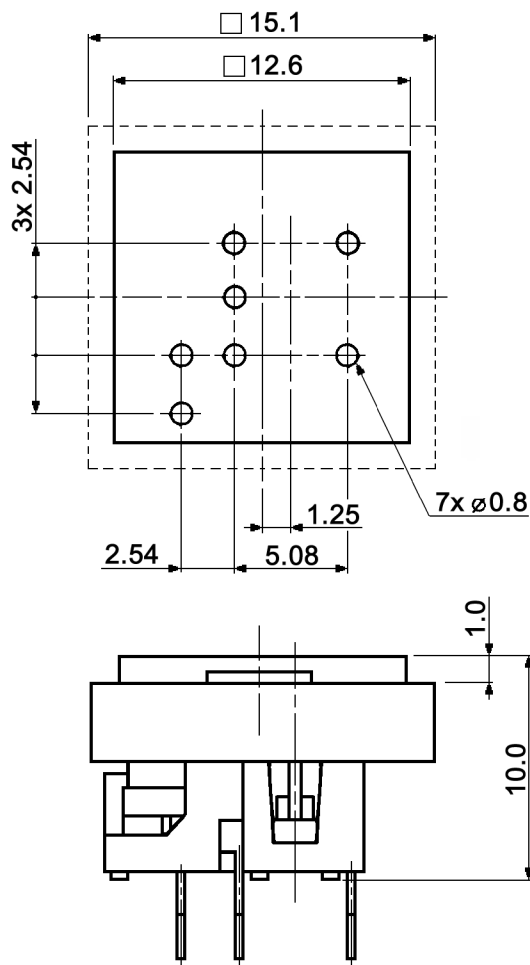

Bezels:

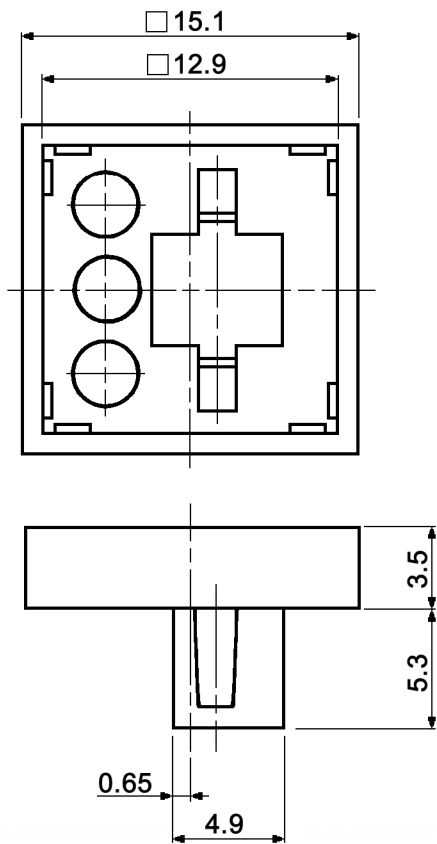

- | Color | Type |
|------------|---------|
| dark grey | FM 3017 |
| grey | FM 3007 |
| light grey | FM 3027 |
| ivory | FM 3011 |



Tolerances:			Date	Name
			01/09	dr
Modifications	Date	Name		

TR 3-Lx / TM 3-Lx

knitter-switch

20 09 91

Page
2/2