



SWITCH FUNCTION

Model No.	POS. 1	POS. 2
		
SSP 1 FB	ON	MOM
Term. Comm.	2-1	2-3

P.C. MOUNTING

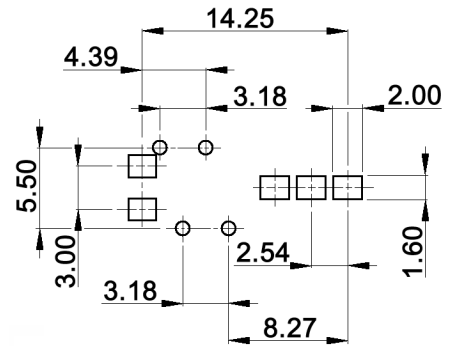

Specifications:

- Contact rating: 0.4VA max., 20V max. (AC or DC)
- Contact resistance: 20mOhm max.
- Insulation resistance: 1 000MOhm min.
- Dielectric strength: 1 500V RMS
- Operating temperature: -30°C to +85°C
- Electrical life: 30 000 make-and-break cycles at full load
- Material: Movable contact: copper alloy, gold plated over nickel plated
Terminals: copper alloy, gold plated over nickel plated

Soldering conditions:

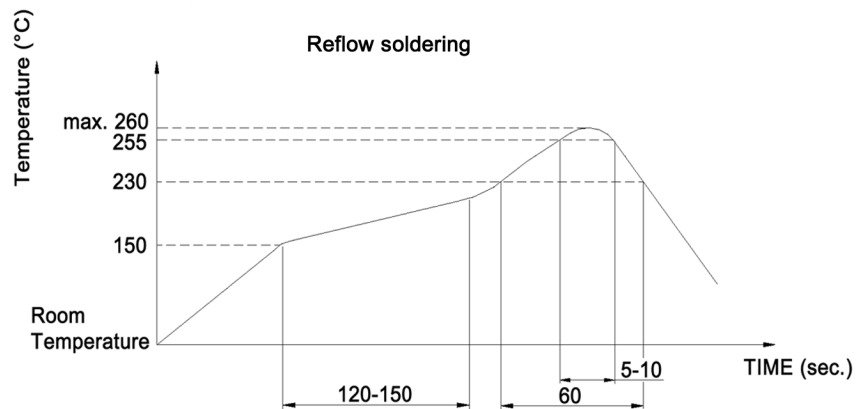

Tolerances: 0.00 to 30.00: ±0.20mm 30.01 to 80.00: ±0.25mm	Date	Name
	02/09	dr
Dimension	03/09	dr
Modifications	Date	Name

SSP 1 FB-VM

knitter-switch

30 17 25

Page

1/1