

P.C. MOUNTING

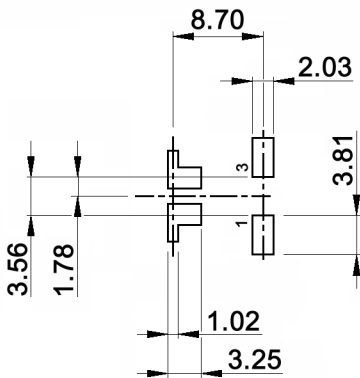

SWITCH FUNCTION

Model No.	POS. 1	POS. 2
SSP 1 CB	OFF	MOM
Term. Comm.	OPEN	1-3

Specifications:

- Contact rating: 0.4VA max.; 20V max. (AC or DC)
- Contact resistance: 20mOhm max. at 2-4V DC
- Insulation resistance: 1 000MOhm min.
- Dielectric strength: 1 000V RMS
- Operating temperature: -30°C to +85°C
- Mechanical life: 50 000 make-and-break cycles
- General tolerances: 0.00mm - +/-0.25mm
0.0mm - +/-0.40mm

RoHS compliant

Material: Case / bushing: glass filled nylon 66, flame retardant, heat stabilized (UL94V-0)
Plunger: thermoplastic polyester (UL94V-0)
Switch support: brass or steel electrotin plated
Contact: gold plated copper alloy

Maßstab		Datum	Name	<h1>SSP 1 CB-R</h1>
Oberfläche		12/06	dr	
Soldering conditions	12/06	dr	knitter-switch	<h2>30 10 27</h2>
Zust	Änderung	Datum	Name	Blatt 1/2

Soldering conditions:

Temperature Profile

Zone	Room temperature	Time
Pre-heat (A)	150°C	min. 120sec.
Soak (B)	180°C - 200°C	min. 150sec.
Peak (C)	200°C - 235°C	min. 30sec.
Peak (D)	235°C - 260°C	min. 40sec.
Peak (E)	260°C	max. 10sec.

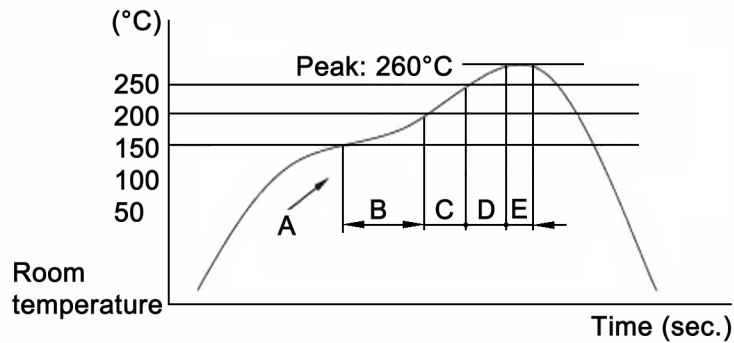

Manual soldering: use soldering iron of 30 watts,
controlled at 350°C approximately
5 seconds while applying solder.

Maßstab		Datum		Name		<h1>SSP 1 CB-R</h1>	
Oberfläche		12/06		dr			
		knitter-switch				<h2>30 10 27</h2>	Blatt
						2/2	
Zust	Änderung	Datum	Name				