

SWITCH FUNCTION

Model No.	POS. 1	POS. 2	POS. 3
MZE 103	ON	OFF	ON
Term. Conn.	2-3	OPEN	2-1

P.C. MOUNTING

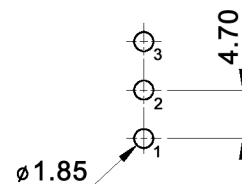

Specifications:

Contact rating: 0.4VA max., 20V max. (AC or DC)
 Contact resistance: 10mOhm max. at 2-4V DC
 Insulation resistance: 1 000MOhm min.
 Dielectric strength: 1 000V RMS
 Operating temperature: -30°C to +85°C
 Mechanical life: 30 000 make-and-break cycles
 Material: Case / bushing: glass filled nylon 66, flame retardant, heat stabilized (UL94V-0)
 Actuator: brass, chrome plated
 Contact / terminal: copper alloy, gold plated over silver



Tolerances: 0.00: ±0.25mm 0.0: ±0.40mm	Date	Name
	01/10	dr

MZME 1 EG PC TA B4

Modifications	Date	Name	knitter-switch	30 19 91	Page
					1/1