

SWITCH FUNCTION

Model. No.	POS. 1	POS. 2	POS. 3
MZME 1 DX	ON	NONE	ON
Term. Comm.	2-3	OPEN	2-1

P.C. MOUNTING

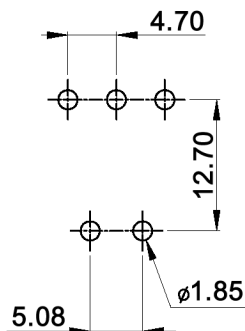

Specifications:

Contact rating: 0.4VA max.; 20V max. (AC or DC)
 Contact resistance: 10mOhm max. at 2-4V DC
 Insulation resistance: 1 000MOhm min.
 Dielectric strength: 1 000V RMS
 Operating temperature: -30°C to +85°C
 Mechanical life: 30 000 make-and-break cycles

RoHS compliant
Material:

Case / bushing: glass filled nylon 66, flame retardant, heat stabilized (UL94V-0)

Actuator: brass, chrome plated
 Switch support: brass, tin plated
 Switch support retainer: stainless steel
 Contact / terminal: gold plated over tin

Maßstab		Datum	Name	MZME 1 DX-RA
Oberfläche		03/07	dr	
		knitter-switch		30 10 86
Zust	Änderung	Datum	Name	Blatt 1/1