

PANEL MOUNTING

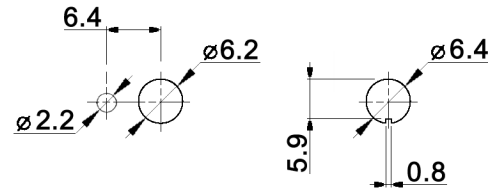

CONTACT ARRANGEMENT

| code for x | function | toggle towards keyway | toggle opposite to keyway |
|------------|----------|-----------------------|---------------------------|
| N          | On-On    | 1-2, 4-5              | 2-3, 5-6                  |
| R          | Mom-On   | 1-2, 4-5              | 2-3, 5-6                  |

| code for x | function    | toggle towards keyway | toggle in center | toggle opposite to keyway |
|------------|-------------|-----------------------|------------------|---------------------------|
| P          | On-Off-On   | 1-2, 4-5              | open             | 2-3, 5-6                  |
| S          | Mom-Off-Mom |                       |                  |                           |
| T          | Mom-Off-On  | 1-2, 4-5              | 2-3, 4-5         | 2-3, 5-6                  |
| PA         | On-On-On    |                       |                  |                           |
| SA         | Mom-On-Mom  |                       |                  |                           |
| TA         | Mom-On-On   |                       |                  |                           |

Specifications:

- Contact rating: 60mA, 30V DC
- Contact resistance: 20mOhm max.
- Insulation resistance: 1 000MOhm min. at 500V DC
- Dielectric strength: 1 500V, 50Hz for the duration of 1 minute
- Operating temperature: -45°C to +140°C
- Mechanical life: min. 200 000 cycles (SA, TA: 100 000 cycles)
- Soldering conditions: hand-soldering: max.: 420°C, 3sec., 60W  
auto-soldering: max.: 270°C, 5sec.
- Mounting instruction: max. torque: 49Ncm
- Material: Terminal: brass, gold plated over nickel  
Case: DAP  
Housing: stainless steel, CNS9265  
Bushing: copper alloy, C3604BD nickel plated  
Actuator: copper alloy, C3604BD chrome plated
- Included accessories: 2 pcs. nut M6x0.75, nickel plated, 9mm wrench size  
1 pc. tooth washer  
1 pc. locking washer



|   |       |      |
|---|-------|------|
| Tolerances: 0.00: ±0.25mm<br>0.0: ±0.40mm | Date  | Name |
|   | 08/09 | dr   |
|   |       |      |
|   |       |      |
|   |       |      |

MTA 206 x B

|                |       |      |                       |                 |      |
|----------------|-------|------|-----------------------|-----------------|------|
| Dimension      | 01/11 | dr   | <b>knitter-switch</b> | <b>30 19 04</b> | Page |
| Panel mounting | 05/10 | dr   |                       |                 | 1/1  |
| Modifications  | Date  | Name |                       |                 |      |