

**PANEL MOUNTING**

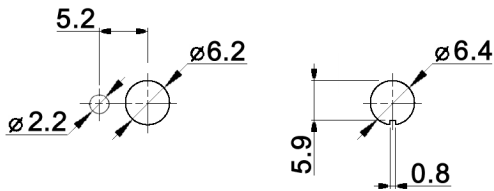

**SWITCH FUNCTION**

	POS. 1	POS. 2	POS. 3
x			
D	ON	-	ON
E	ON	OFF	ON
F	MOM	-	ON
G	MOM	OFF	MOM
H	MOM	OFF	ON

**Specifications:**

- Contact rating: 60mA, 30V DC
- Contact resistance: 10mOhm max.
- Insulation resistance: 1 000MOhm min. at 500V DC
- Dielectric strength: 1 500V, 50Hz for the duration of 1 minute
- Operating temperature: -45°C to +140°C
- Mechanical life: min. 200 000 cycles
- Soldering conditions: hand-soldering: max.: 420°C, 3sec., 60W  
auto-soldering: max.: 270°C, 5sec.
- Mounting instruction: max. torque: 49Ncm
- Material: Terminal: brass, gold plated over nickel  
Case: DAP  
Housing: stainless steel, CNS9265  
Bushing: copper alloy, C3604BD nickel plated  
Actuator: copper alloy, C3604BD chrome plated
- Included accessories: 2 pcs. nut M6x0.75, nickel plated, 9mm wrench size  
1 pc. tooth washer  
1 pc. locking washer



Tolerances: 0.00: ±0.25mm 0.0: ±0.40mm	Date	Name
	02/09	dr
Dimension	01/11	dr
Panel mounting	05/10	dr
Modifications	Date	Name

**MTA 106 xB-5.2**

**knitter-switch**

**30 17 14**

Page

1/1