

SCHEMATIC

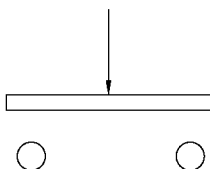

P.C.B. LAYOUT

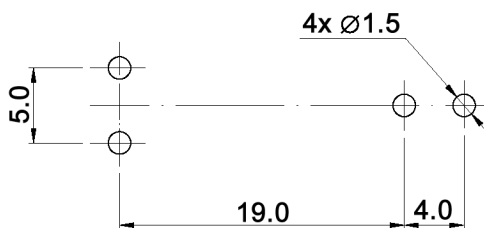

Tolerances: 0.00: $\pm 0.25\text{mm}$ 0.0: $\pm 0.40\text{mm}$	Date	Name
	05/09	dr

MSP 101 A-RA

knitter-switch

30 18 32

Page

1/2

Modifications	Date	Name
---------------	------	------

Specifications:

Contact rating: 1A, 120 AC or 28V DC
 Contact resistance: 30mOhm max.
 Insulation resistance: 100MOhm min. at 500V DC
 Operating temperature: -20°C to +70°C
 Mechanical life: 10 000 cycles
 Operating force: 650 +/-150gf max.
 Included accessories: 1 pc. tooth washer
 1 pc. nut
 Material: Case: brass, nickel plated
 Actuator: PA66
 Base: POM
 Contacts: phosphor bronze, silver plated over nickel
 Terminals: brass, silver plated over nickel



Tolerances: 0.00: ±0.25mm 0.0: ±0.40mm		Date	Name	<h1>MSP 101 A-RA</h1>
		05/09	dr	
		knitter-switch		<h2>30 18 32</h2>
				Page 2/2
Modifications	Date	Name		