

P.C. LAYOUT

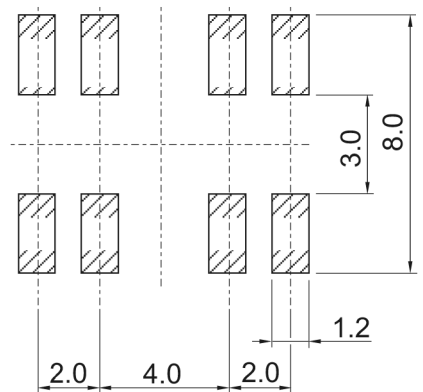

Specifications:

- Contact rating: 0.3A, 6V DC
- Contact resistance: 70mOhm max.
- Insulation resistance: 100MOhm min. at 500V DC for 1 minute
- Dielectric strength: 500V AC (50/60Hz, 2mA) for 1 minute
- Operating temperature: -10°C to +85°C
- Mechanical life: 5 000 cycles min.
- Operating force: a-b c-b: 200gf +/-100gf
b-a b-c: 300gf +/-150gf

- Material:
 - 1 - Case: PA46, black
 - 2 - Contact plate: C1720HM
 - 3 - Slider: PA46, blue
 - 4 - Cover: SUS, washing
 - 5 - Terminal: brass strip, silver plated

SCHEMATIC

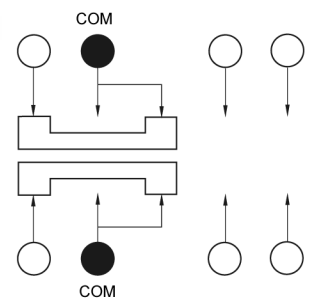

Tolerances: up to 10: ±0.2mm above 10-50: ±0.3mm above 50-100: ±0.5mm	Date	Name
	09/07	dr

MMS 238 T

Material	06/09	dr
Slider position	06/08	dr
Operating temperature	12/07	dr
Modifications	Date	Name

knitter-switch

30 12 36

Page

1/3

Packaging:

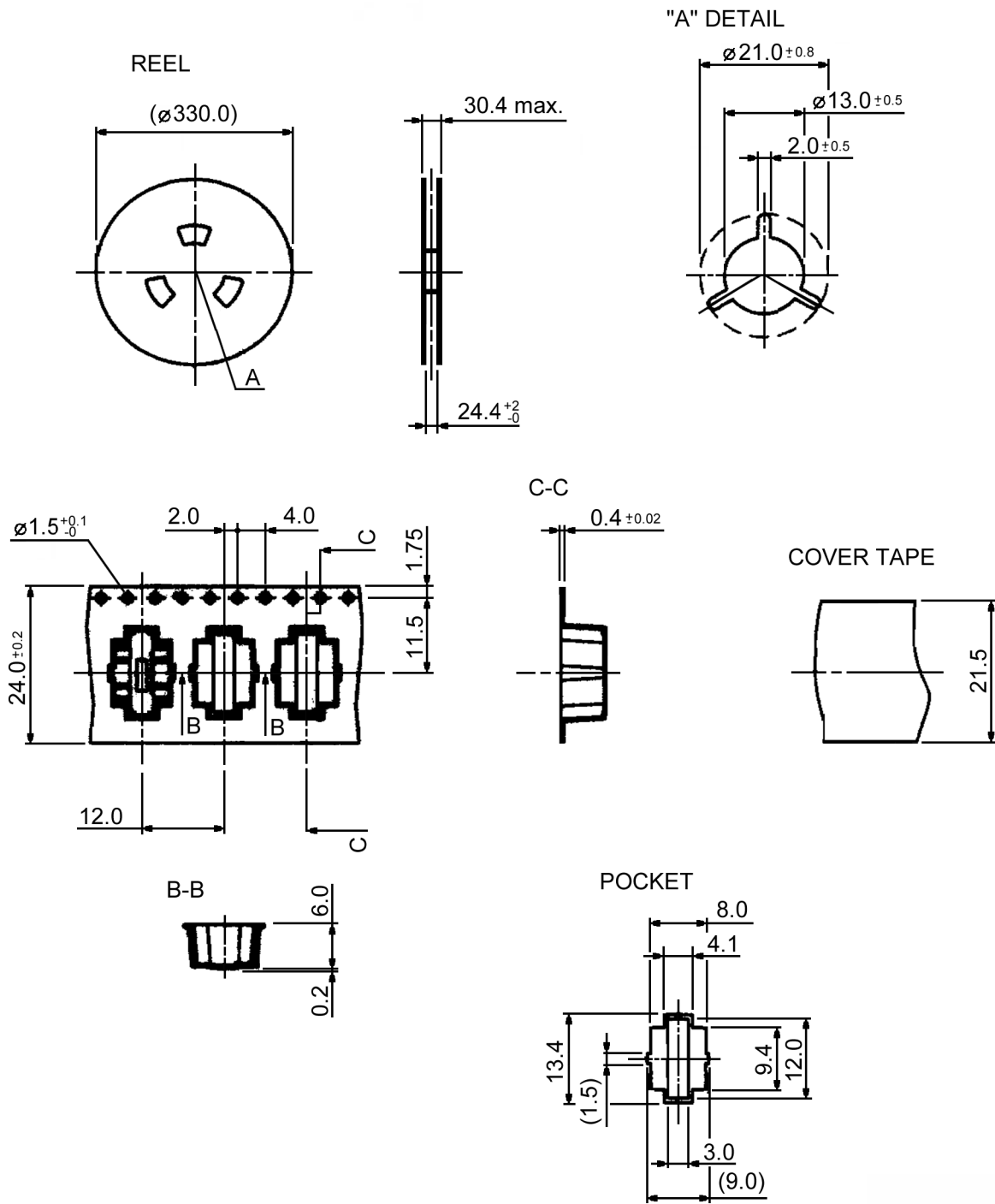

Packaging: 900 pcs. / reel



Tolerances: up to 10: $\pm 0.2\text{mm}$ above 10-50: $\pm 0.3\text{mm}$ above 50-100: $\pm 0.5\text{mm}$	Date	Name	<h1>MMS 238 T</h1>
	09/07	dr	
Modifications	Date	Name	
knitter-switch			30 12 36
			Page 3/3