

P.C.B. LAYOUT

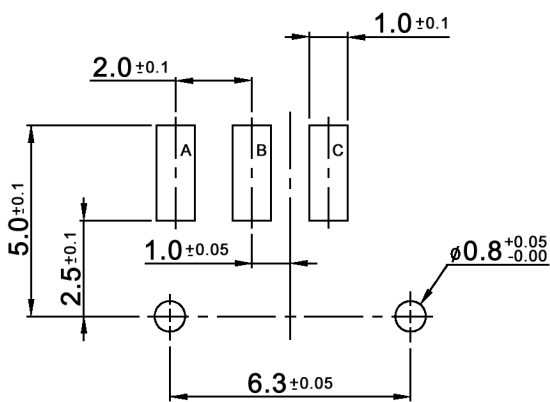

CIRCUIT DIAGRAM

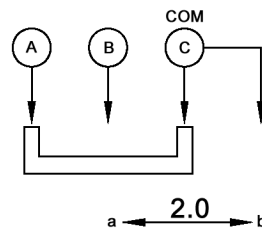

Tolerances: ±0.20mm max.	Date	Name
	06/11	dr
Modifications	Date	Name

MMS 1263 SLRP

knitter-switch

30 23 79

Page

1/2

Specifications:

Contact rating: non-switching: 100mA, 50V DC
 switching: 25mA, 24V DC
Contact resistance: 100mOhm max.
Insulation resistance: 100MOhm min. at 500V DC for 1 minute +/-5sec.
Dielectric strength: 500V AC (50/60Hz) for 1 minute
Operating temperature: -20°C to +70°C
Storage temperature: -40°C to +85°C
Electrical life: 10 000 cycles
Operating force: min.: 100gf; max.: 350gf
Material: Cover: stainless steel
 Stem / base: high-temp. thermoplastic LCP, molded black
 Contact: copper, gold plated
 Spring: piano wire
 Terminal: brass, gold plated

Soldering conditions:

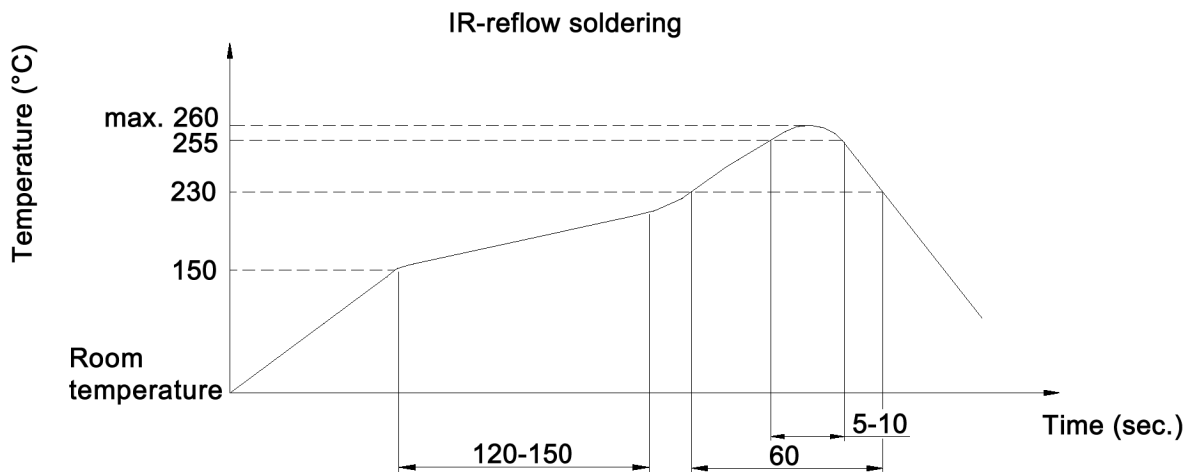

Tolerances: ±0.20mm max.			Date	Name	<h1>MMS 1263 SLRP</h1>
			06/11	dr	
			knitter-switch		<h2>30 23 79</h2>
Modifications			Date	Name	Page 2/2