

P.C.B. LAYOUT

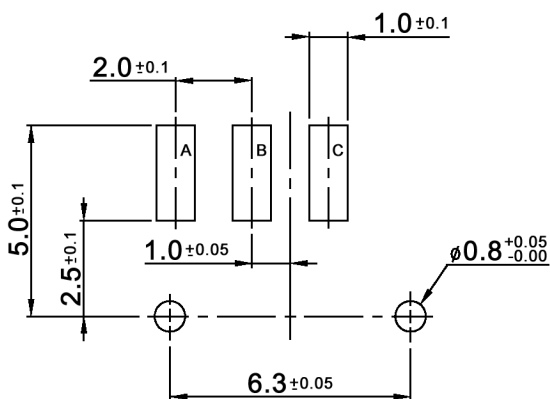

CIRCUIT DIAGRAM

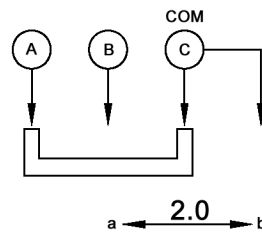

Tolerances: ±0.20mm max.	Date	Name
	06/11	dr
Modifications	Date	Name

MMS 1263 DLRP

knitter-switch

30 23 83

Page

1/2

**Specifications:**

**Contact rating:** non-switching: 100mA, 50V DC  
 switching: 25mA, 24V DC  
**Contact resistance:** 100mOhm max.  
**Insulation resistance:** 100MOhm min. at 500V DC for 1 minute +/-5sec.  
**Dielectric strength:** 500V AC (50/60Hz) for 1 minute  
**Operating temperature:** -20°C to +70°C  
**Storage temperature:** -40°C to +85°C  
**Electrical life:** 10 000 cycles  
**Operating force:** min.: 100gf; max.: 350gf  
**Material:** Cover: stainless steel  
 Stem / base: high-temp. thermoplastic LCP, molded black  
 Contact: copper, gold plated  
 Spring: piano wire  
 Terminal: brass, gold plated

**Soldering conditions:**

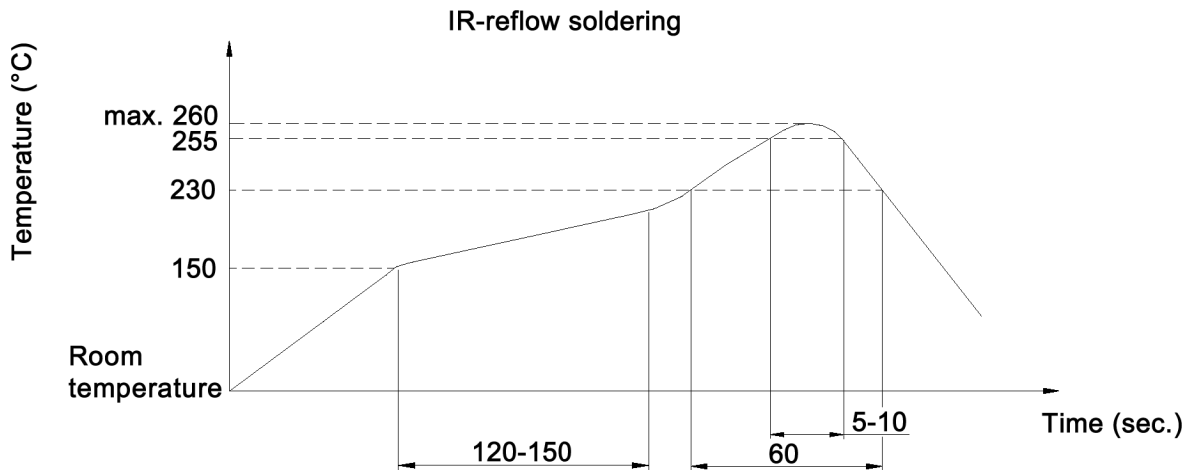

Tolerances: ±0.20mm max.	Date	Name
	06/11	dr
Modifications	Date	Name

**MMS 1263 DLRP**

**knitter-switch**

**30 23 83**

Page

2/2