

SCHEMATIC

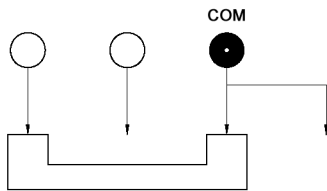

P.C.B. LAYOUT

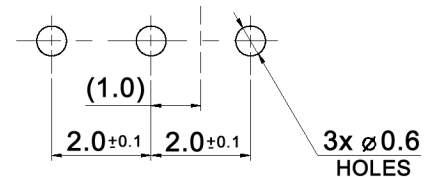

Specifications:

- Contact rating: 0.3A, 4V DC
- Contact resistance: 70mOhm max.
- Insulation resistance: 100MOhm min. at 500V DC
- Dielectric strength: 500V AC for 1 minute
- Operating temperature: -40°C to +85°C
- Mechanical life: 10 000 cycles
- Operating force: 120 +/-75gf
- Soldering conditions: pre-heat: max. 100°C, max. 60sec.
soldering: max. 260°C, max. 3-5sec.

Material:

- Contact / terminal: copper alloy, silver plated
- Frame: liquid crystal polymer, black
- Slider: polyamide, glass fiber, white
- Cover: stainless steel



Tolerances: ±0.3mm	Date	Name
	01/11	dr
Modifications	Date	Name

MMP 124 R

30 22 77

Page

1/1

knitter-switch