

HOLE LAYOUT  $\oplus 0.05$

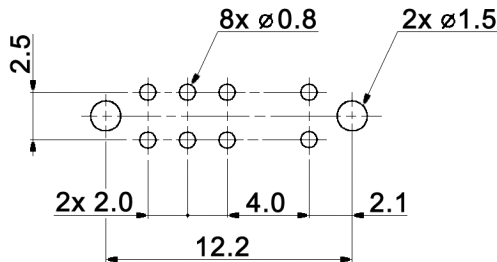

Specifications:

- Contact rating: 0.1A, 12V DC
- Contact resistance: 20mOhm max.
- Insulation resistance: 100MOhm min. at 500V AC for 1minute
- Dielectric strength: 500V AC (50/60Hz, 2mA) for 1 minute
- Operating temperature: -10°C to +60°C
- Mechanical life: 10 000 cycles
- Operating force: 250 +/-100gf
- Soldering conditions: 260 +/-5°C, 5 +/-1sec.
- Material:
  - Spring plate: phosphor bronze, washing
  - Contact clip: phosphor bronze, silver plated
  - Slider: POM, black
  - Terminal: brass strip, silver plated
  - Base: phenolic resin, natural
  - Frame: steel, tin plated

CIRCUIT DIAGRAM  
C: COMMON PIN  
BOTTOM VIEW

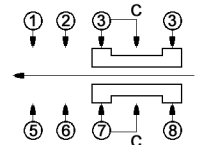

Tolerances: up to 10: ±0.2mm above 10-50: ±0.3mm	Date	Name
	04/10	dr

**MFP 213 P**

**knitter-switch**

**30 20 65**

Page

1/1

Modifications	Date	Name
---------------	------	------