

OUTPUT SIGNAL FORMAT

Shaft rotational direction	Signal	Output
C.W.	Terminal A-C	OFF ON
	Terminal B-C	OFF ON
C.C.W.	Terminal A-C	OFF ON
	Terminal B-C	OFF ON

Specifications:

Contact rating:	0.5mA, 5V DC
Contact resistance:	100mOhm max.
Insulation resistance:	100MOhm min. at 250V DC
Dielectric strength:	300V AC for 1 minute
Operating temperature:	-40°C to +85°C
Storage temperature:	-40°C to +85°C
Mechanical life:	20 000 cycles
Operating force:	300 +150/-100gf
Rotational life:	30 000 cycles
Rotational torque:	100gf.cm max.
Resolution:	24 pulses / 360°
No. of detents:	no detents
Soldering conditions:	260 +/-5°C, 5 +/-1sec.

TERMINAL DETAIL

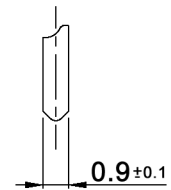

P.C.B. MOUNTING VIEWED FROM MOUNTING SIDE t=1.6mm

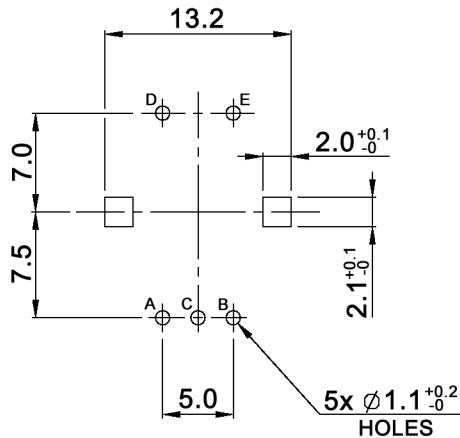

CIRCUIT DIAGRAM

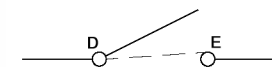

Tolerances: ≤ 10: ±0.3mm 10 - 100: ±0.5mm	Date	Name
	10/10	dr
Output signal format	03/11	dr
Modifications	Date	Name

MERP12-24N125

knitter-switch

30 21 99

Page

1/1