

SHAFT FLAT IS OPTIONAL ANGLE

TERMINAL DETAIL

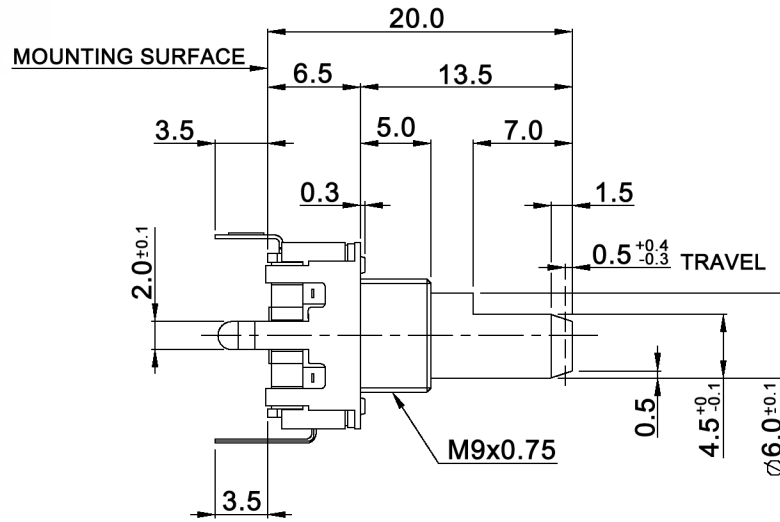

CIRCUIT DIAGRAM

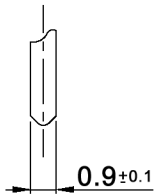

P.C.B. MOUNTING
(TOLERANCE ±0.1)
VIEWED FROM MOUNTING SIDE
t=1.6mm

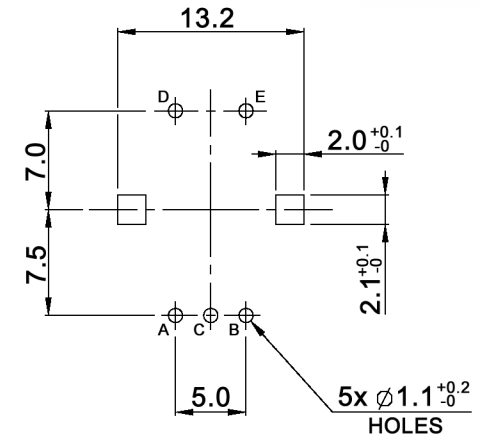

Tolerances: ≤10: ±0.3mm 10-100: ±0.5mm		Date	Name	<h1>MERP12-24N120M9</h1>
		02/11	dr	
Output signal format	03/11	dr	knitter-switch	<h2>30 22 86</h2>
Modifications	Date	Name		

Specifications:

Contact rating: 0.5mA, 5V DC
 Contact resistance: 100mOhm max.
 Insulation resistance: 100MOhm min. at 250V DC
 Dielectric strength: 300V AC for 1 minute
 Operating temperature: -40°C to +85°C
 Storage temperature: -40°C to +85°C
 Mechanical life: 20 000 cycles
 Operating force: 300 +/-150gf
 Rotational life: 30 000 cycles
 Rotational torque: 50gf.cm (max.)
 Resolution: 24 pulses / turn
 No. of detents: no detents
 Soldering conditions: max. 260 +/-5°C, 5 +/-1sec.
 pre-heat: max. 100°C, max. 120sec.

OUTPUT SIGNAL FORMAT

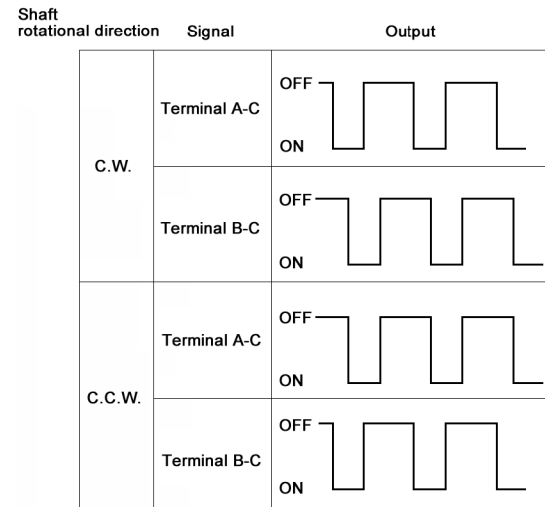

Tolerances: ≤10: ±0.3mm 10-100: ±0.5mm		Date	Name	MERP12-24N120M9
		02/11	dr	
			knitter-switch	30 22 86
Modifications		Date	Name	Page 2/2