

SHAFT FLAT IS OPTIONAL ANGLE

P.C.B. MOUNTING
(TOLERANCE ± 0.1)
VIEWED FROM MOUNTING SIDE
 $t=1.6\text{mm}$

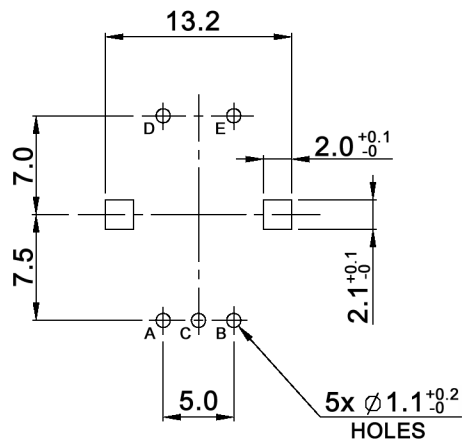

OUTPUT SIGNAL FORMAT

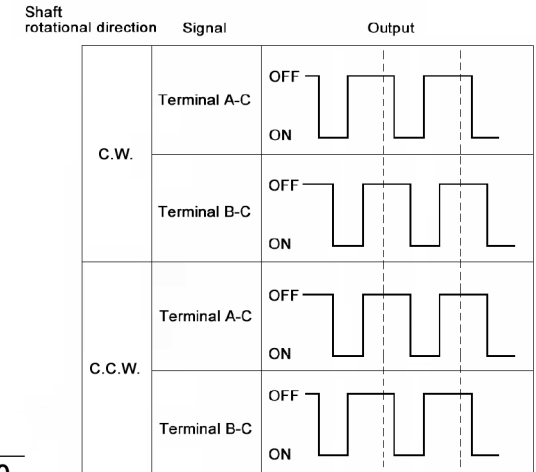

h	LM	L1
17.5	17.5	5.0
20	20.0	7.0
25	25.0	12.0
30	30.0	12.0

Specifications:

Contact rating:	10mA, 5V DC
Contact resistance:	100mOhm max.
Insulation resistance:	100MOhm min. at 250V DC
Dielectric strength:	300V AC for 1 minute
Operating temperature:	-40°C to +85°C
Storage temperature:	-40°C to +85°C
Resolution:	12 pulses / 360° for each phase
Detent torque:	30-200gf.cm
No. and pos. of detents:	12 detents; step angle: 30° +/-3°
Rotational life:	30 000 cycles
Soldering conditions:	260 +/-5°C, 5 +/-1sec.
Switch:	Mechanical life: 20 000 cycles
	Operating force: 300 +150/-100gf

CIRCUIT DIAGRAM

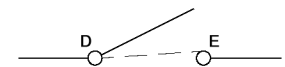

TERMINAL DETAIL

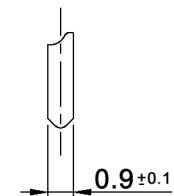

Tolerances: $\leq 10: \pm 0.3\text{mm}$ $10-100: \pm 0.5\text{mm}$		Date	Name
		03/11	dr
Rename	04/11	dr	
Modifications	Date	Name	

MERP12-12P1h

knitter-switch

30 23 45

Page

1/1