

Output signal format

Shaft rotational direction	Signal	Output
C.W.	Terminal A-C	OFF ON
	Terminal B-C	OFF ON
C.C.W.	Terminal A-C	OFF ON
	Terminal B-C	OFF ON

h	LM1	L1
15	15.0	3.0
17.5	17.5	5.0
20	20.0	6.0
25	25.0	12.0
30	30.0	12.0

CIRCUIT DIAGRAM



Specifications:

Contact rating: 10mA, 5V DC  
 Contact resistance: 100mOhm max.  
 Insulation resistance: 100MOhm min. at 250V DC / 1mA  
 Dielectric strength: 300V AC for 1 minute  
 Operating temperature: -40°C to +85°C  
 Storage temperature: -40°C to +85°C  
 Rotational life: 30 000 cycles  
 Detent torque: 3-20mNm  
 Resolution: 12 pulses  
 No. of detents: 24 detents; step angle: 15° +/-3°  
 Soldering conditions: 260 +/-5°C, 3 +/-1.0sec.  
 Switch: Travel: 0.5<sup>+0.4</sup>/<sub>-0.3</sub> mm  
 Mechanical life: 20 000 cycles  
 Operating force: 3 +/-1N

TERMINAL DETAIL

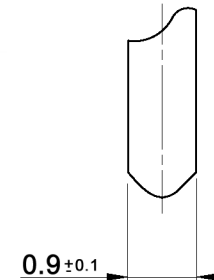

P.C. MOUNTING

t=1.6mm

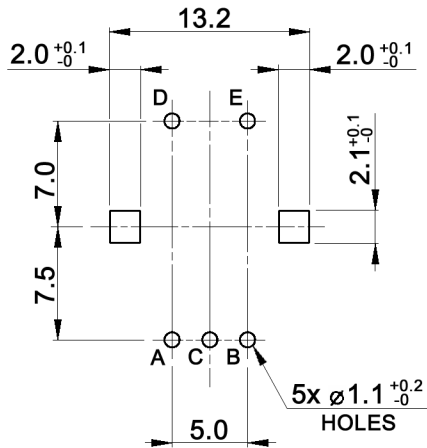

Tolerances: ≤10: ±0.3mm		Date	Name
10-100: ±0.5mm		12/10	dr
Rename	03/11	dr	
Modifications	Date	Name	

MERP12-121h

knitter-switch

30 22 51

Page

1/1