

ATE 1-RA-1

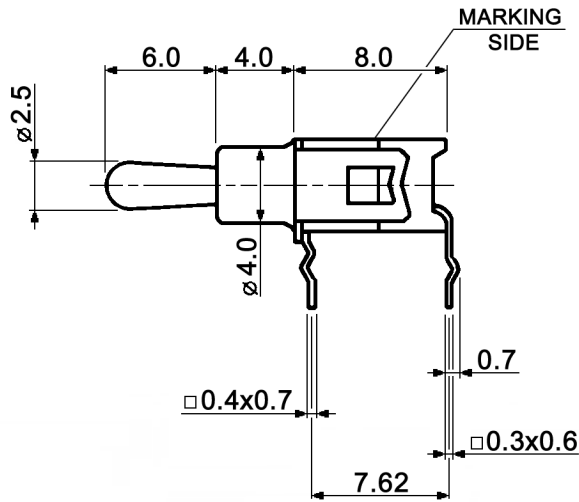

P.C. MOUNTING

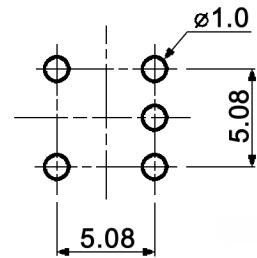

ATE 2-RA-1

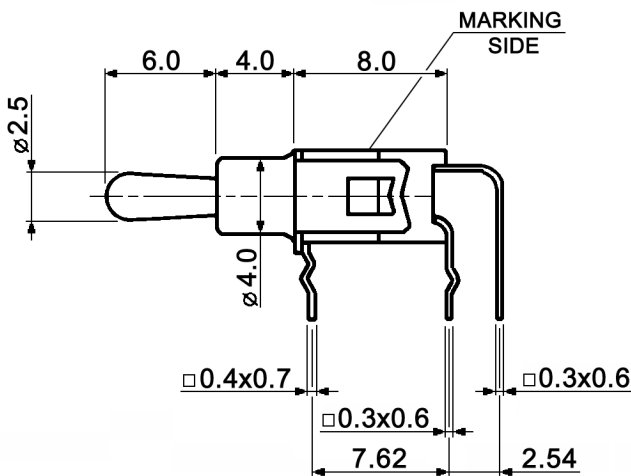

P.C. MOUNTING

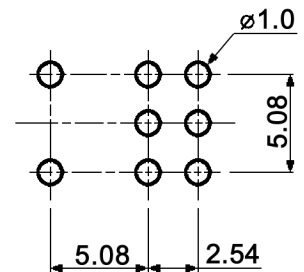

Tolerances:			Date	Name
			10/09	dr
Revised	10/09	dr		
Modifications	Date	Name		

ATE 1-RA-1 / ATE 2-RA-1

knitter-switch

20 25 82

Page

1/2

Specifications:

Contact rating: max.: 0.4VA, 48V AC/DC / max. 50mA  
 min.: 1µA, 20mV AC/DC  
 Contact resistance: 50mOhm max.  
 Insulation resistance: 500MOhm min. at 250V DC  
 Dielectric strength: 50V, 50Hz for duration of 1 minute  
 Operating temperature: -20°C to +85°C  
 Mechanical life: min. 60 000 cycles  
 Soldering conditions: auto-soldering: max.: 260 +/-5°C, 5 +/-1.0sec.  
 Mounting: on pc-board  
 Contacts: phosphor bronze gold plated over nickel barrier  
 Terminals: PC terminals, crimped  
 Material: Case: PBT, meets UL94V-0, washable  
 Metal parts: nickel plated brass  
 UL file number: E140532

x	Switch function
D	on - on
E	on - off - on
F	mom - on
G	mom - off - mom
H	mom - off - on

Lever position:  
 For code F and H: "mom" is on the right side  
 when looking at the marking side.  
 The closed contacts are opposite to the lever  
 position.



Tolerances:			Date	Name	<b>ATE 1-RA-1 / ATE 2-RA-1</b>
			10/09	dr	
			<b>knitter-switch</b>		<b>20 25 82</b>
Modifications			Date	Name	Page 2/2