

P.C. LAYOUT

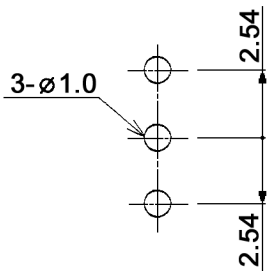

Specifications:

- Contact rating: max. 50mA, 48V AC/DC; min. 1µA, 20mV AC/DC
- Contact resistance: 50mOhm max. at 1.5mA, 200µA AC
- Insulation resistance: 500MOhm min. at 250V DC
- Dielectric strength: 250V AC for 1 minute
- Temperature range: -20°C to +80°C
- Mechanical life: max. rating: 10 000 cycles; min. rating: 50 000 cycles
- Operating force: 70 - 500gf
- Mounting: on pc-board
- Soldering conditions: auto-soldering: max.: 260 +/-5°C, 5 +/-1sec.
- Switching function: on - off - on
- Material: Terminal / contact: phosphor bronze, gold plated  
Lever: PBT resin, black  
Frame: brass, nickel plated  
Case: PBT resin, gray



Tolerances:			Date	Name	<b>ASL 1 E</b>	
			05/06	dr		
			<b>knitter-switch</b>		<b>30 08 79</b>	
Soldering conditions			10/06	dr	Page	
Modifications			Date	Name	1/1	